

Unique characteristics

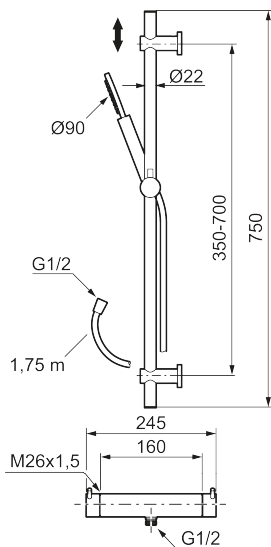

MORA INXX II shower kit

Article number: 271600.LD6 Flow 3 bar: 6.0 l/m

Description: Chrome, LEED compliant

Consist of:

MORA INXX II shower mixer:

- Pressure balanced thermostatic mixer
- Temperature handle with safety stop at 38°C
- With Eco-function
- Approved non-return valves, EN-Standard EN1717

MORA INXX II shower:

- Shower hose in metal, PVC- and BPA-free
- With adjustable wall brackets for usage of existing screw holes
- With Easy-Clean anti-limescale system
- Constant flow 6 l/min at 200–600 kPa